

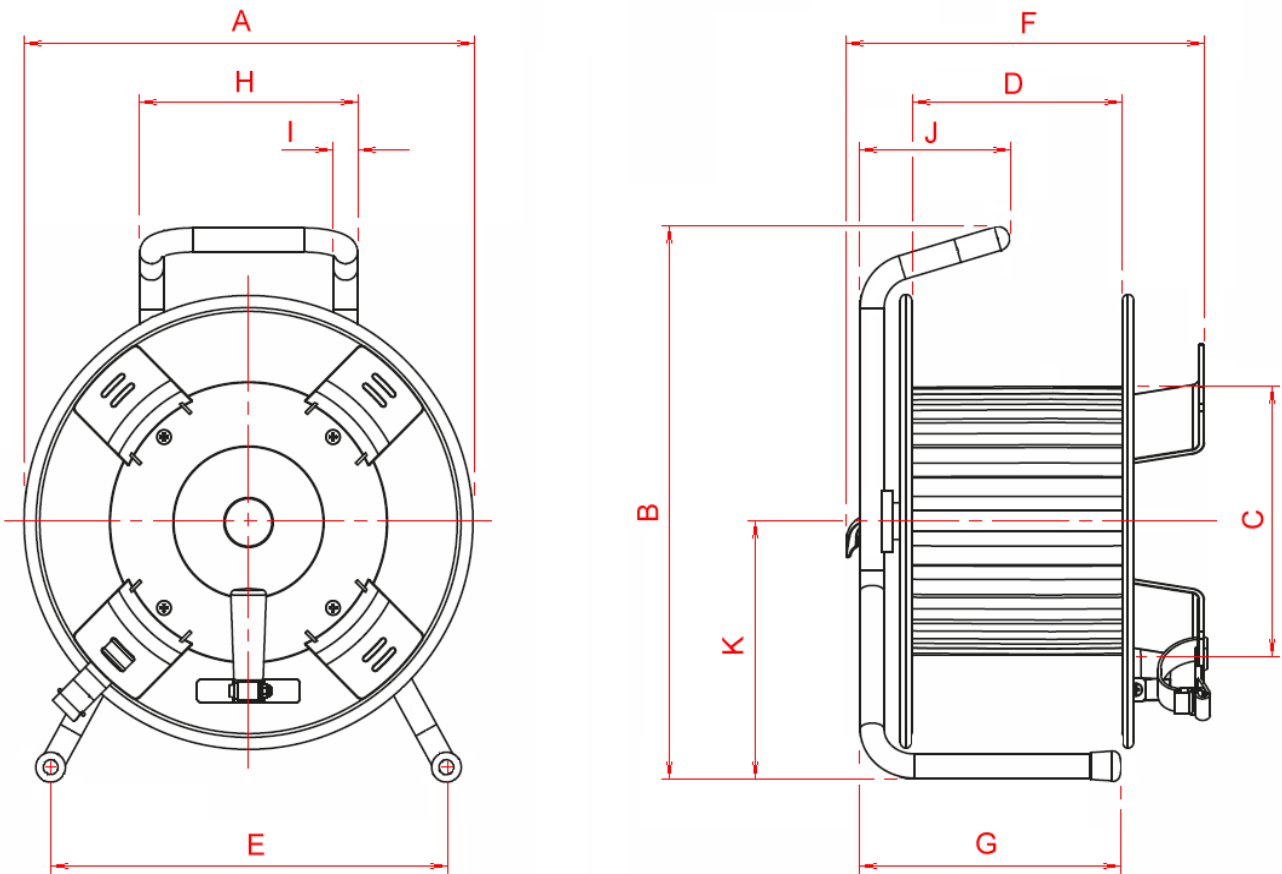

Robust cable-drum, steel drum with steel tube frame. Friction drum-brake incorporated into the frame to prevent movement in transit. 'Cable tail' type drum with solid steel flange open hub plus four brackets on the flange face to enable the cable tail to be brought out from the hub of the drum at a gentle angle (important for coaxial and essential for fibre cables) and coiled and secured around the brackets.. Fixed handle. Black finish.

Dimensions:



A	300mm	D	141mm	G	174mm	J	100mm
B	365mm	E	265mm	H	146mm	K	170mm
C	178mm	F	242mm	I	16mm		

Weight: 3.6 kg

Capacity: 6.5mm cable 134m 12.5mm cable 38m 15.9mm cable 16m

For more capacities use the online cable drum calculator

<http://www.canford.co.uk/Technical/Article/CableDrumCalculator?portable=true>